

LOCATION PLAN

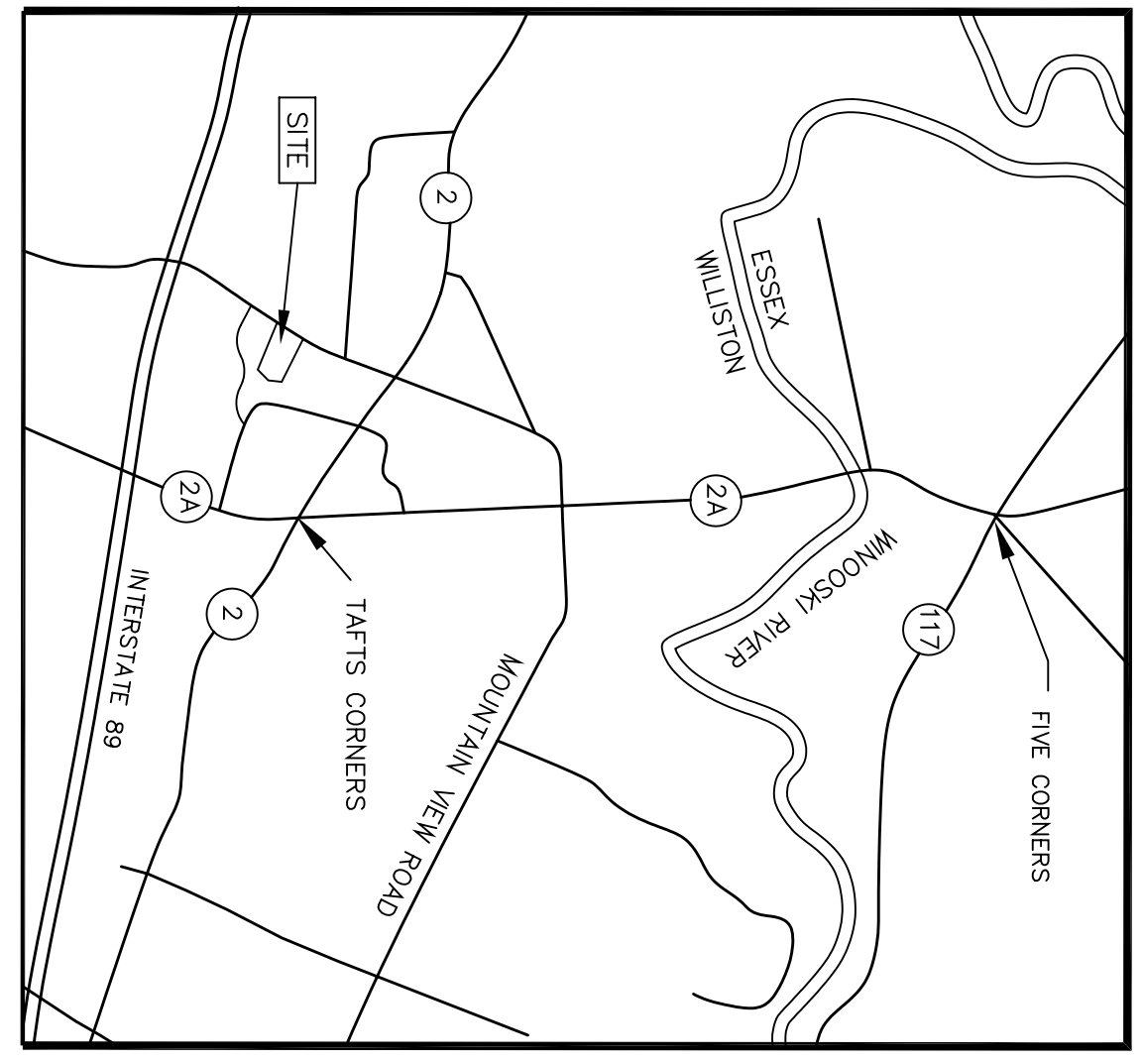

| DATE | DESCRIPTION | BY |
|----------|---|-----|
| 9-15-99 | REVISED BUILDING 3 FOOTPRINT AND SIGNWALKS | PJP |
| 6-30-99 | REVISED POND GRADING AND PHASE II CLEANINGS | PJP |
| 6-24-99 | REVISED DUMPSTER LOCATION FOR PHASE II | PJP |
| 6-17-99 | REVISED GRADING | PJP |
| 6-10-99 | REVISED LAYOUT FOR BUILDINGS 3 & 4 | PJP |
| 5-31-99 | REVISED UNDERBRAN SLOPE BETWEEN BUILDINGS 1 & 3 | PJP |
| 5-23-99 | REVISED WATER LINE AND PROPERTY LINE | PJP |
| 4-16-99 | REVISED LAYOUT FOR BUILDINGS 3 & 4 | PJP |
| 2-22-99 | REVISED AS PER ACT 250 & ANR | PJP |
| 1-27-99 | REVISED AS PER DEVELOPMENT REVIEW BOARD | PJP |
| 12-11-98 | REVERSE STORMWATER POND | PJP |

| DATE | DESCRIPTION | BY |
|---------|----------------------|-----|
| 9-14-98 | FINAL RECORD DRAWING | PJP |

| DATE | DESCRIPTION | BY |
|---------|----------------------|-----|
| 9-14-98 | FINAL RECORD DRAWING | PJP |

| DATE | DESCRIPTION | BY |
|---------|----------------------|-----|
| 9-14-98 | FINAL RECORD DRAWING | PJP |

THE CONTRACTOR SHALL NOTIFY "DIGSAFE" AT 1-888-DIG-SAFE PRIOR TO ANY EXCAVATION.